

PARTS LIST					PARTS LIST				
ITEM	VENDOR	DESCRIPTION	PART NUMBER	QTY	ITEM	VENDOR	DESCRIPTION	PART NUMBER	QTY
19	Digikey	Microswitch	SW768-ND	2	1		Button Head Cap Screw - Metric	BHCS - M8 x 1.25 x 35	1
20	Lulzbot	Nema 17 Stepper Motor	Nema 17 Stepper Motor	1	2		Flat Washers	Flat Washer - 3 N	4
21	Lulzbot	Motor Pulley	HD-MS0033	1	3		Flat Washers	Flat Washer - 5 N	8
22	Lulzbot	X Axis Belt	HD-BL0009	1	4		Flat Washers - Extra Wide	Flat Washer - 5 R	4
23	McMaster	2mm Heat Insert	94180A307	4	5		Flat Washers	Flat Washer - 8 N	2
24	McMaster	3mm Heat Insert	94180A331	9	6		Hex Jam Nut	HJN - M5 x 0.8	4
25	McMaster	5mm Heat Insert	94180A361	8	7		Low Head Socket Cap Screw - Metric	LHCS - M6x1 x 35	1
26	McMaster	5mm Heat Insert	94180A363	6	8		Nylock Hex Nut - Metric	NHN - M5 x 0.8	5
27	McMaster	STAINLESS STEEL BALL BEARING	6153K111	2	9		Nylock Hex Nut - Metric	NHN - M6 x 1	1
28	Openbuilds	Aluminum Spacer 6mm	Aluminum Spacer 6mm	4	10		Nylock Hex Nut - Metric	NHN - M8 x 1.25	1
29	Openbuilds	Low Head Socket Cap Screw - Metric	LHCS - M5x0.8 x 25	2	11		Socket Head Cap Screw - Metric	SHCS - M2x0.4 x 8	4
30	Openbuilds	Low Head Socket Cap Screw - Metric	LHCS - M5x0.8 x 30	2	12		Socket Head Cap Screw - Metric	SHCS - M3x0.5 x 10	4
31	Openbuilds	Low Head Socket Cap Screw - Metric	LHCS - M5x0.8 x 35	3	13		Socket Head Cap Screw - Metric	SHCS - M3x0.5 x 12	4
32	Openbuilds	V-Slot Gantry Plate 20-80mm	V-Slot Gantry Plate 20-80mm - SKU 621	1	14		Socket Head Cap Screw - Metric	SHCS - M3x0.5 x 8	4
33	Openbuilds	Tee Nut	Tee Nut - SKU 536	12	15		Socket Head Cap Screw - Metric	SHCS - M5x0.8 x 10	12
34	Openbuilds	V-Slot 20x60x500 Linear Rail	V-Slot 20x60x500 Linear Rail - SKU 160- LP	1	16		Socket Head Cap Screw - Metric	SHCS - M5x0.8 x 12	9
35	Openbuilds	Eccentric Spacer 6mm	Eccentric Spacer 6mm	2	17		Socket Head Cap Screw - Metric	SHCS - M5x0.8 x 20	4
36	Openbuilds	Xtreme Solid V Wheel	Xtreme Solid V Wheel - SKU 55	4	18		Socket Head Cap Screw - Metric	SHCS - M5x0.8 x 30	2
37	Openbuilds	Ball Bearing 5 x 16 x 5	Ball Bearing 5 x 16 x 5 - SKU 30	8					
38	Openbuilds	Precision Shim - 10x5x1mm	Precision Shim - 10x5x1mm - SKU 5	8					
	Openbuilds	Individual Wheels and bearing can be replaced with Openbuilds kit SKU 465							
39	Printed		Carriage Guide	1					
40	Printed		Taz_OpenRail_Idler_Endcap	1					
41	Printed		Taz_OpenRail_Idler_Tensioner	1					
42	Printed		Taz_OpenRail_XMotor_Endcap	1					
43	Printed		Taz_OpenRail_Xmotor_Mount_lid	1					
44	Printed		Taz_Openbuild_X_Carriage	1					
45	Printed		Taz_Openbuild_X_backplate_belt_post_spacer	2					
46	Printed		Taz_Openbuild_X_bottom_backplate_spacer	1					
47	Printed		Taz_Openbuild_X_top_backplate_spacer	1					
48	Printed		Taz_Openrail_X_belt_bracket	1					
49	Printed		Taz_Openrail_xmotor_Mount_mainblock	1					
50	Printed / Purchased		Taz_Openbuild_X1_backplate	1					

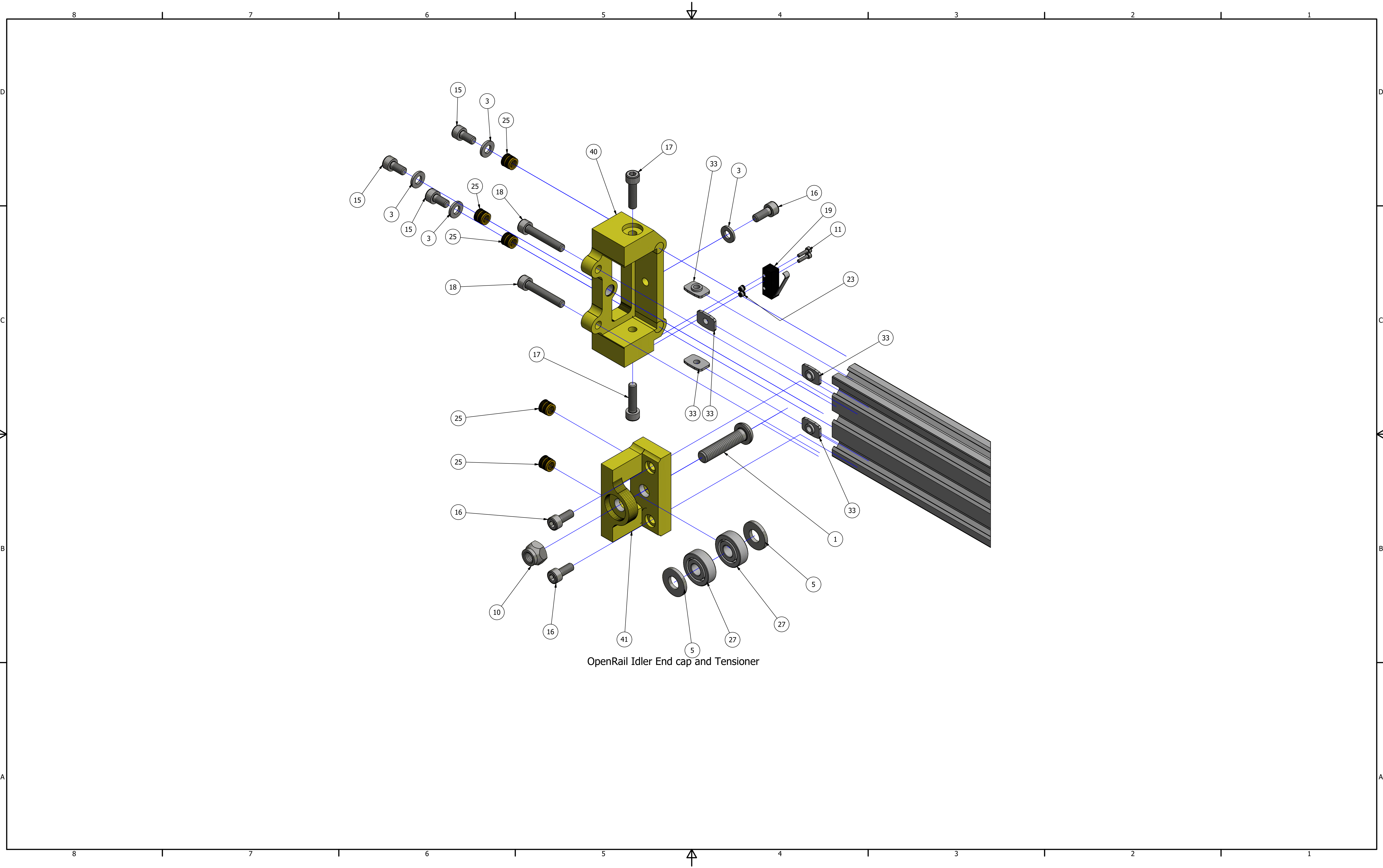

OpenRail Idler End cap and Tensioner

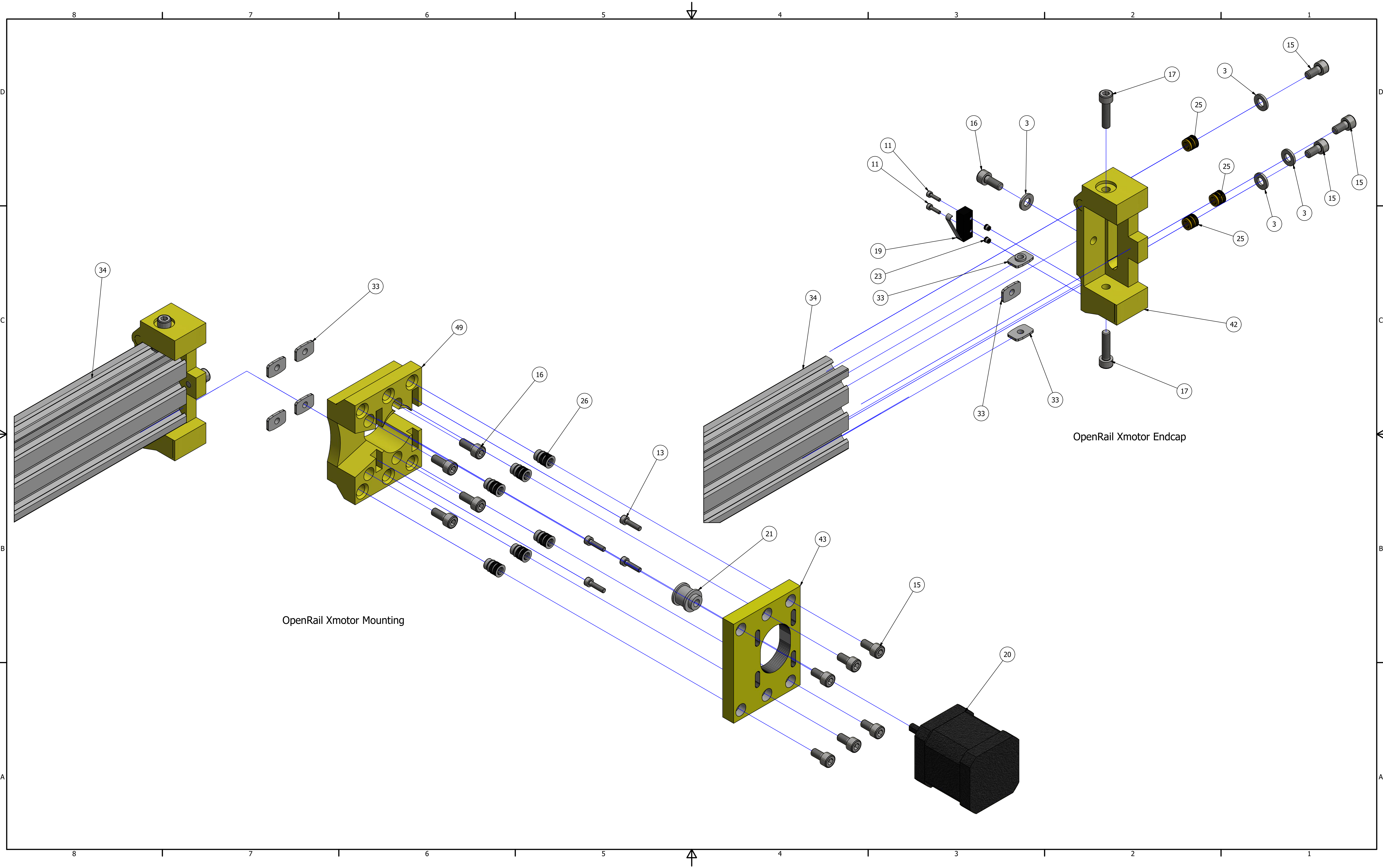

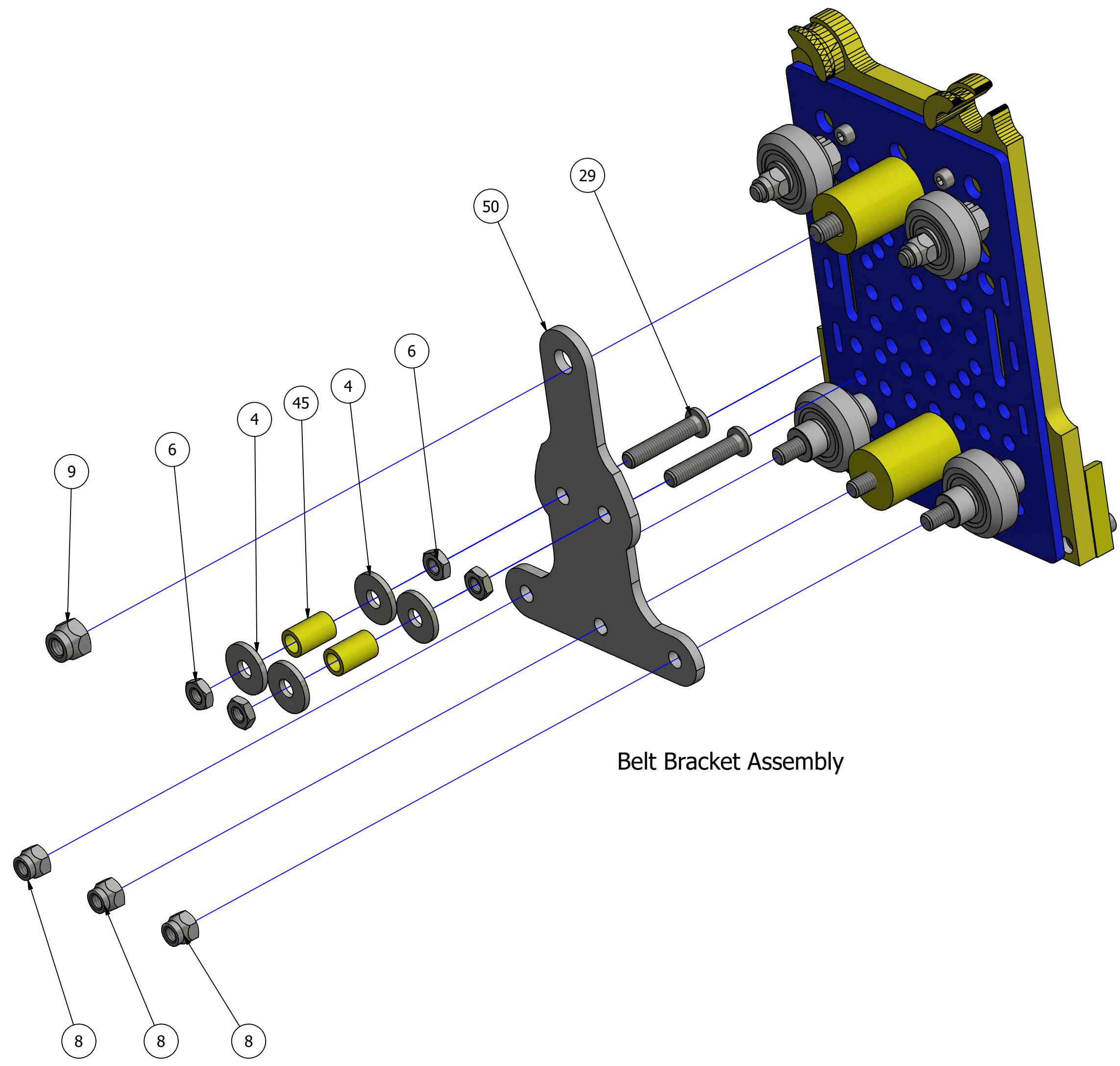

Belt Bracket Assembly

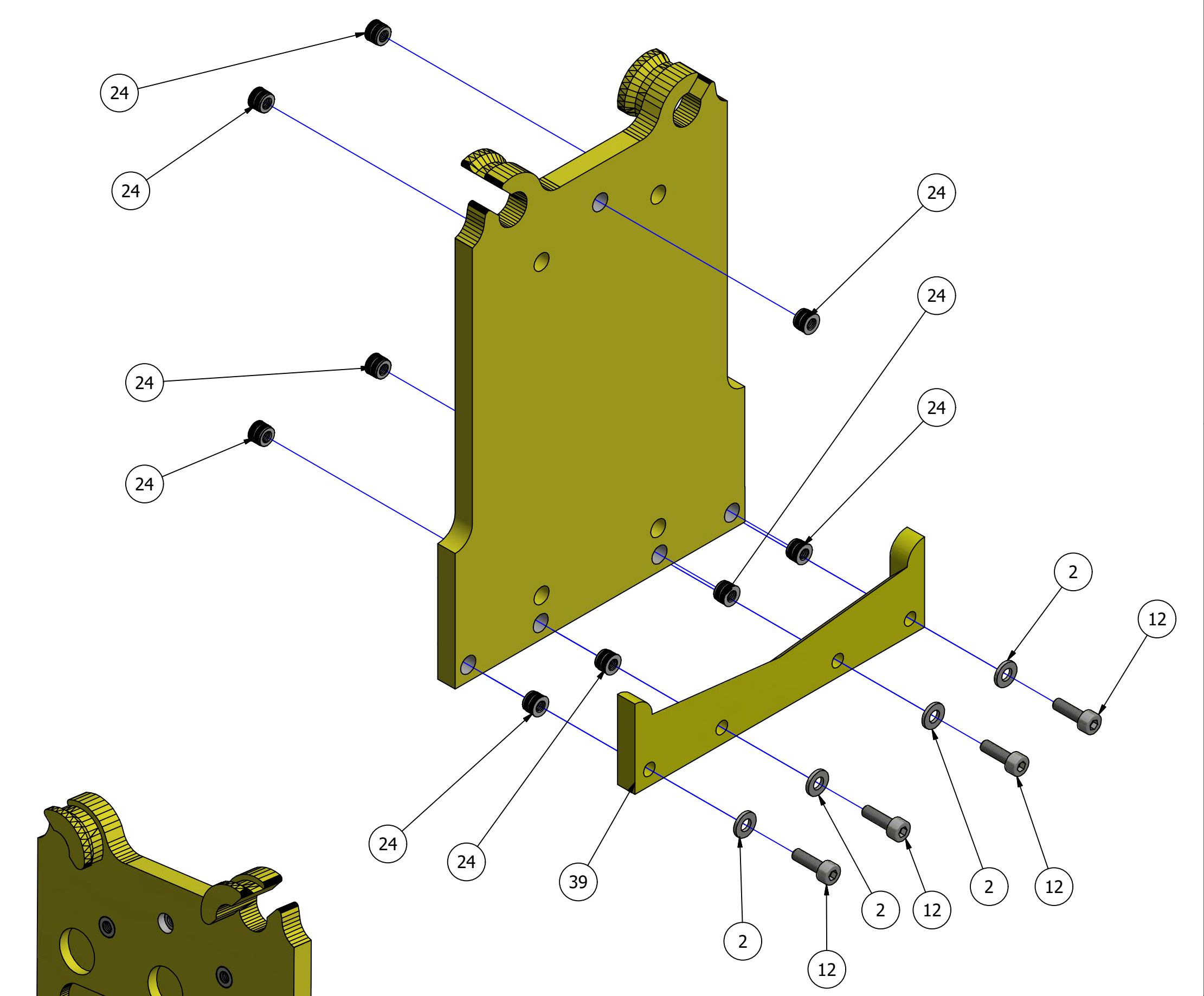

Extruder Holder Assembly

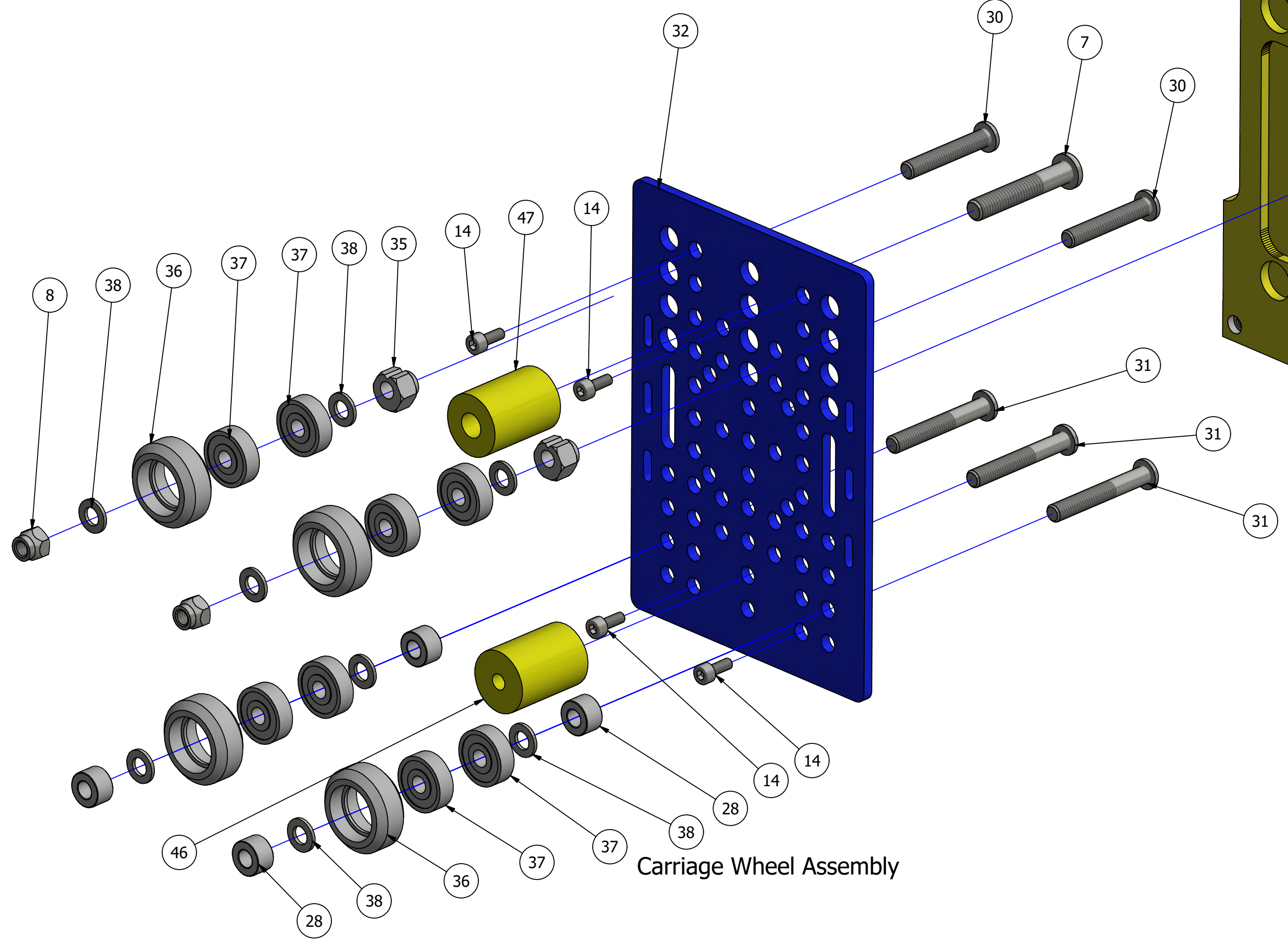

Carriage Wheel Assembly