

18650



26650



Recommended Materials for PRINT

LASERSINTERING: Alumide, PA 2200

FUSED FILAMENT FABRICATION: Not tested and not recommended.

Recommended Materials for PRINT

LASERSINTERING: Alumide, PA 2200

FUSED FILAMENT FABRICATION: ABS, Colorfabb XT CF-20

Parts List 18650

1.Body

2. Door

3. Button

4. Fat Daddy v4 BF Short Version / Fat Daddy Vapes 510 v4 Bottom Feeder Replacement Core

<http://www.modmaker.co.uk/Fat-Daddy-Vapes-510-v4-Short-Bottom-Feeder-Set-22mm-Cap> <http://www.modmaker.co.uk/Fat-Daddy-Vapes-510-v4-Bottom-Feeder-Replacement-Core-3-Pack>

5. Neodym Magnets Upper

https://www.supermagnete.de/quadmagnete-neodym/quadmagnet-10mm-x-3mm-x-2mm-neodym-44h-vernickelt_Q-10-03-02-HN

6. Neodym Magnets Lower

https://www.supermagnete.de/quadmagnete-neodym/quadmagnet-5mm-x-2.5mm-x-1.5mm-neodym-44h-vernickelt_Q-05-2.5-1.5-HN

7. Copper Sheets

Parts List 26650

1.Body

2. Door

3. Button

4. Fat Daddy v4 BF Short Version / Fat Daddy Vapes 510 v4 Bottom Feeder Replacement Core

<http://www.modmaker.co.uk/Fat-Daddy-Vapes-510-v4-Short-Bottom-Feeder-Set-22mm-Cap> <http://www.modmaker.co.uk/Fat-Daddy-Vapes-510-v4-Bottom-Feeder-Replacement-Core-3-Pack>

5. Neodym Magnets Upper and Lower

https://www.supermagnete.de/quadmagnete-neodym/quadmagnet-10mm-x-3mm-x-2mm-neodym-44h-vernickelt_Q-10-03-02-HN

6. Copper Sheets

Shrink tube for coopersheet plus



Button



Coppersheet plus



**FatDaddy V4 BF
short version**



Coppersheet minus



Coppersheet contact 510



**CorePin Fat Daddy
V4 Mech version**

Body



Door



Foam double tape



**Neodym magnets 18650
2x 5 x 2.5 x 1.5 mm
2x 10 x 3 x 2 mm**



**Neodym magnets 26650
4x 10 x 3 x 2 mm**

Copper Sheets spec.

Oxygen Free Copper (OFC)

C1100

E-Cu58 / Cu-ETP

C11000

C1100

Round the edges of the negative sheet, so that the metal plates on the mod cannot be tilted and can be easily removed.

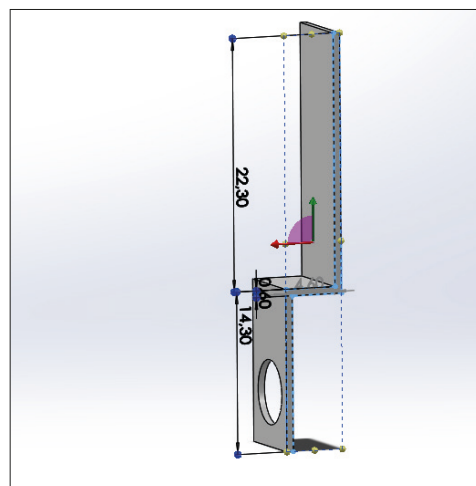
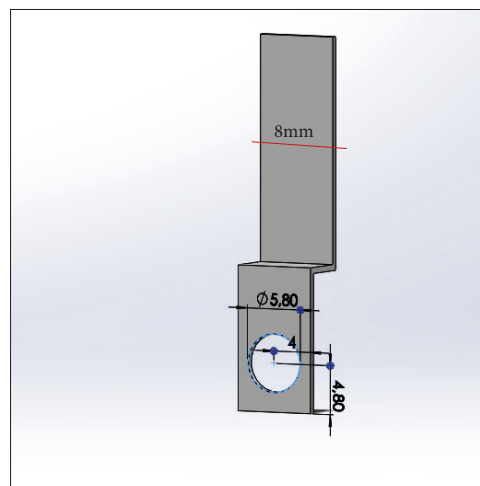
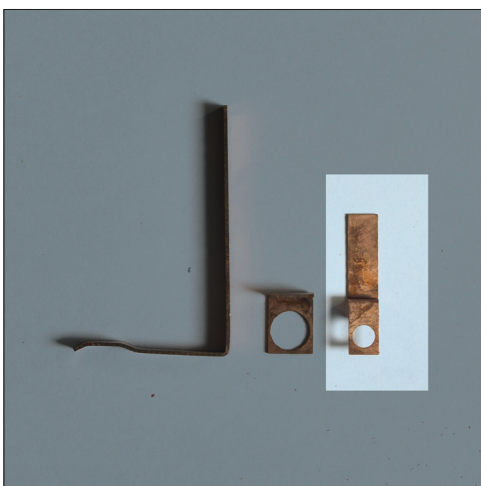
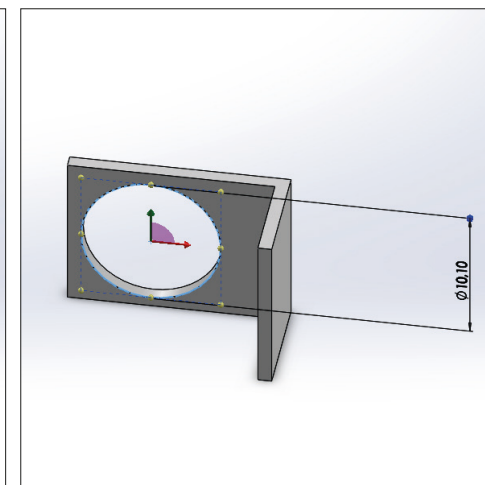
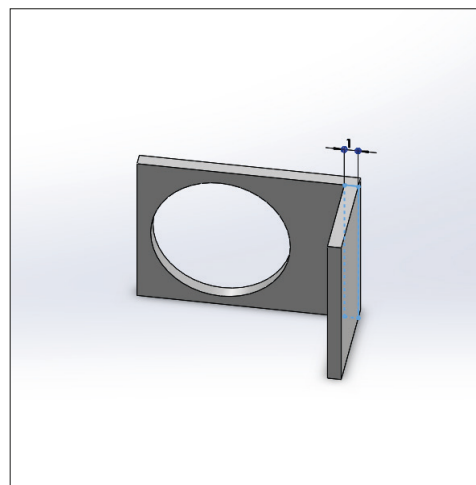
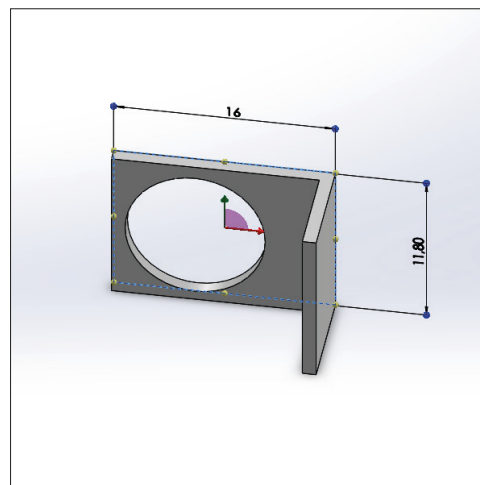
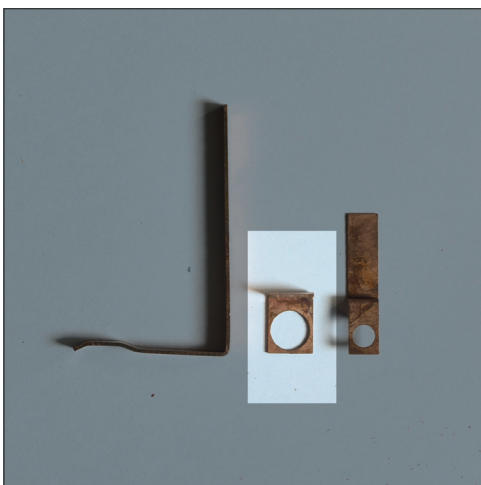
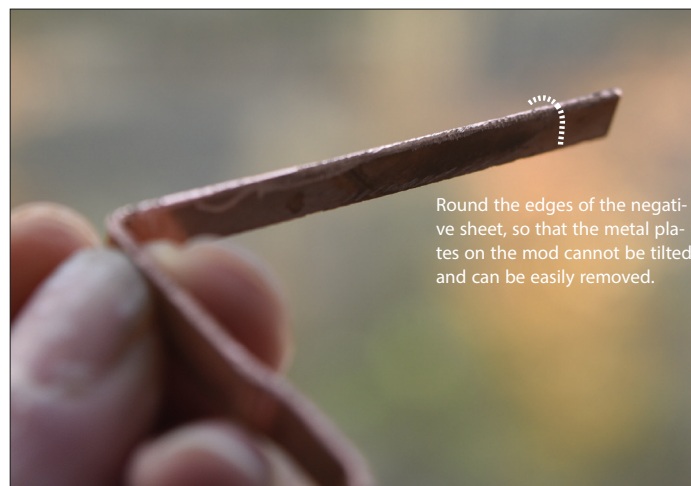
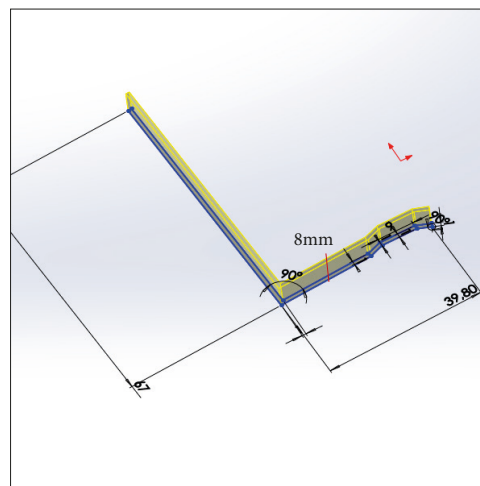
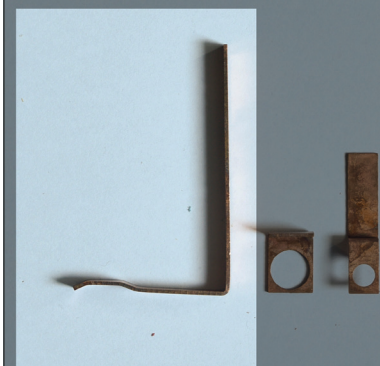

26650: Bend the sheet as in the graphic below. You will get better contact with the battery.



18650: In order to make clean contact with the battery, an increase is needed on the copper plate. You can punch this into the material. You have also to shorten the sheet to fit it in the mod.

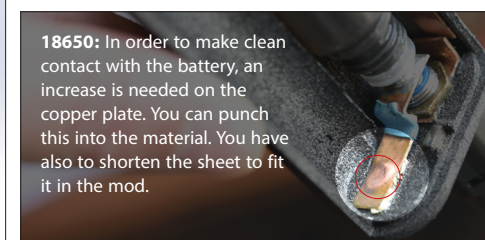

Assembling 18650 / 26650

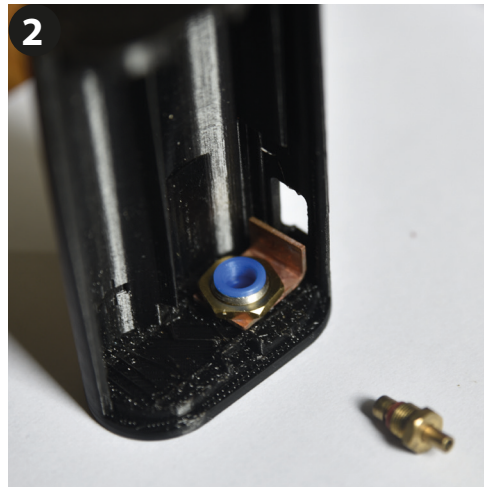
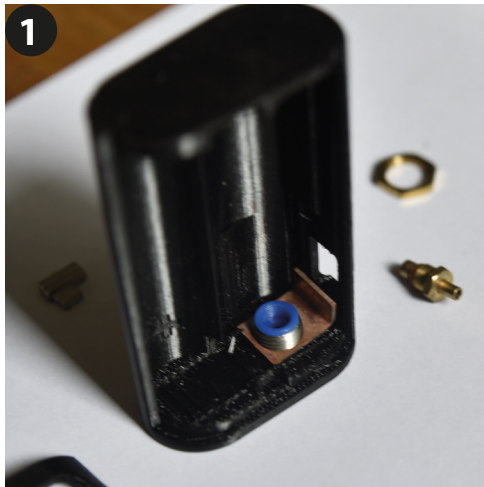

Tighten the 510 nut.
Recommended: Screw locking fluid to prevent the nut from getting loose.



Stick magnets into door and body.
Recommended glue:
UHU Max Repair or UHU PLUS ACRYLIT, Tube Binder

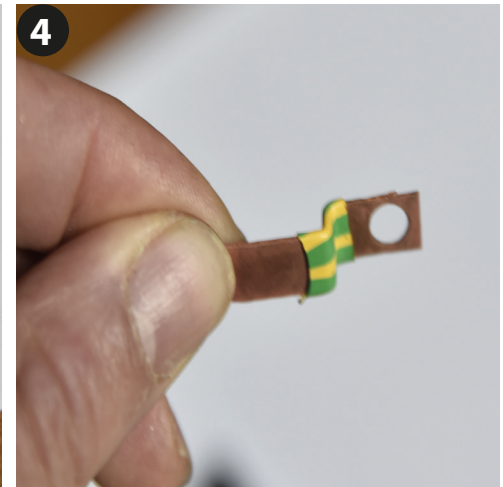

Apply shrink tube to the positive copper sheet.
Important to prevent contact between 510 connection and positive coppersheet.



Apply double foam tape. It prevents the sheet from moving.



Screw in the core pin with the positive copper-sheet attached.

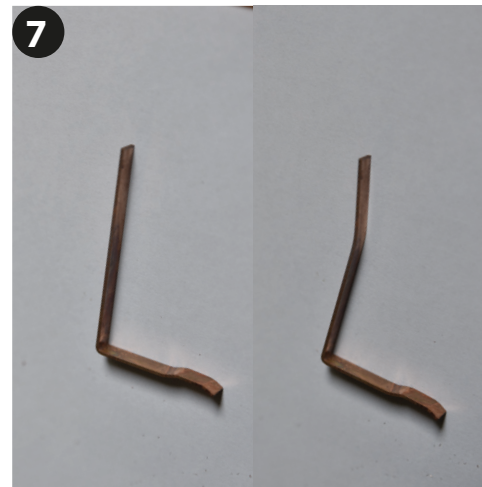

Bend the negative sheet like an L. The pressure point on the button is increased which means the mod is more secure in the pocket.

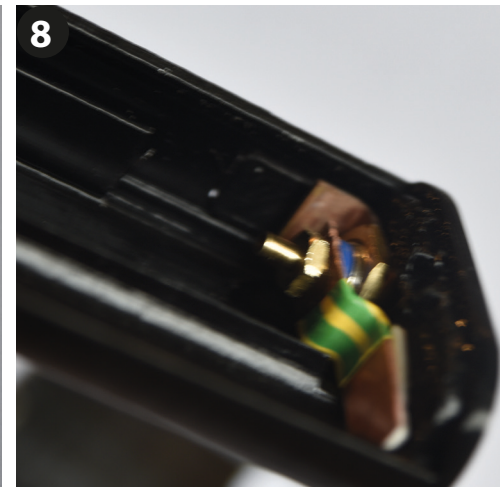

Put in the button.

9

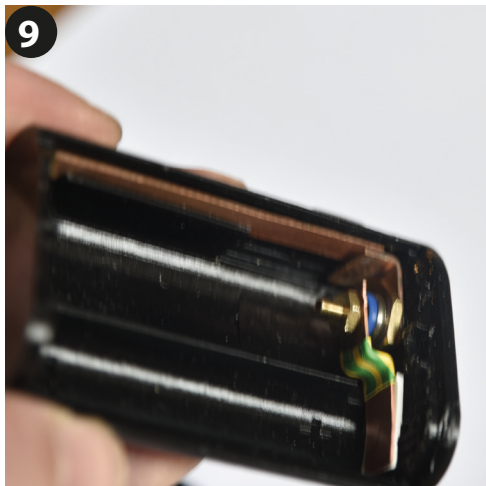

Put in the negative coppersheet.



Before using the Mod please make sure everything is assambled properly and there are no bridges between positive and negative contacts at the 510 connection.

Any liability for compensation for damages and personal injuries as well as for gross negligence or intent is excluded.