

Notes:

1. All gear teeth must be cleaned and smooth to ensure minimal friction.
2. After installing the ring to the center carrier plate, the center carrier housing can be glued to the Center Carrier Plate.
3. All bearings should fit snug onto their both of their mating surfaces.

ITEM NO.	PART NUMBER	QTY.
1	Center Carrier housing	1
2	Center Carrier Plate	1
3	Ring gear	1
4	Spider Gear 1	2
5	Spider Gear 2	2
6	6701ZZ bearing	4
7	m3 6mm SHCS	10
8	3mm x 43mm shaft	1

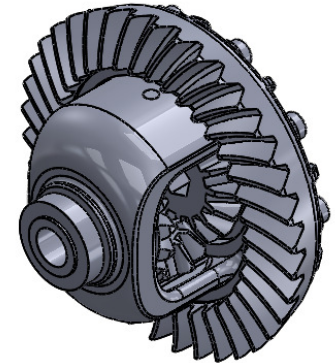
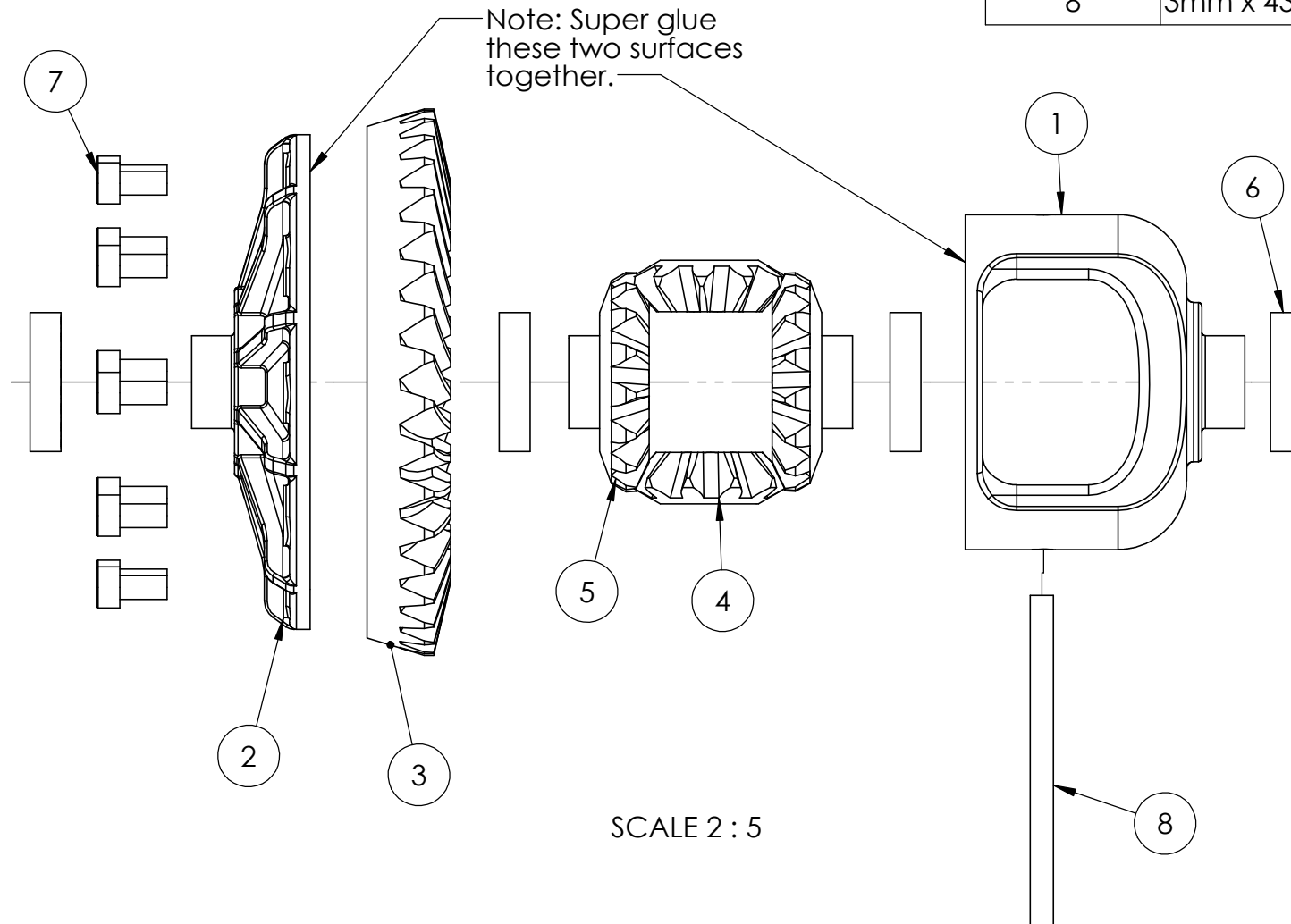

SCALE 1 : 4