



# LIGHTCYCLE

## ASSEMBLY INSTRUCTIONS

**GENERAL ASSEMBLY:** This kit was designed to be printed with a Makerbot Thing-O-Matic, however, it should print well with most any 3D printer without support. It is **not** recommended to re-scale the kit before printing. The kit was designed with a precision fit between parts for ease of assembly, and these tolerances will be lost if the kit is printed at a different scale. It is recommended that the builder examine the instructions carefully and do a **dry test fit of parts before applying cement**. All parts are laid out for printing in separate colors, however, the model can be painted as well.

**PINS:** The kit uses short sections of 3mm filament to align parts during assembly. If you do not use 3mm filament with your printer, there is a file provided to print a set of pins.

**SUB-ASSEMBLIES:** Note that this kit is intended to be built in sub-assemblies. This makes building the kit far more manageable.

Thank you for downloading this kit, and if you have any questions, you can find me as **CBABBAGE** on Thingiverse.com or **@charles\_babbage** on Twitter.

### 0: PARTS

## LIGHTCYCLE

As laid out in their STL files

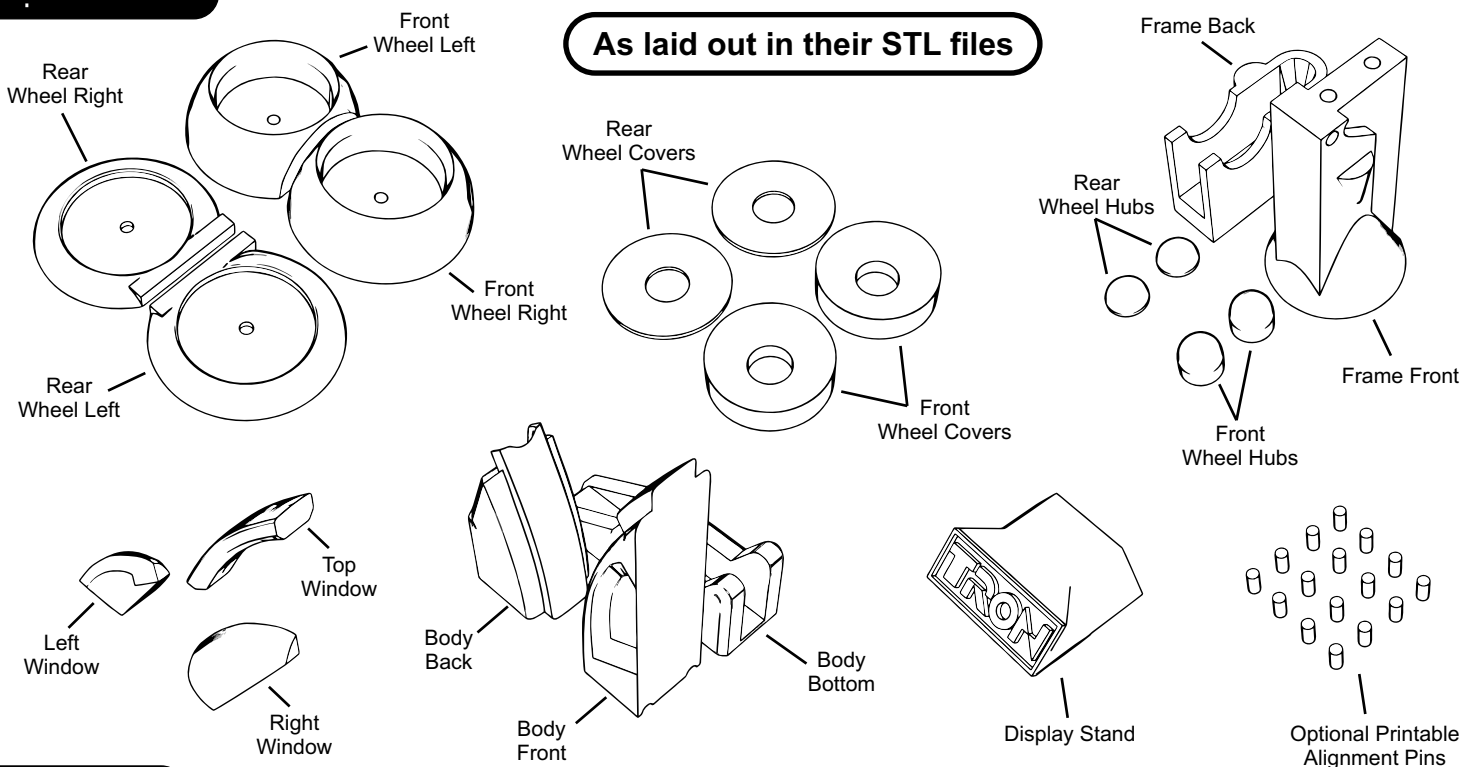

### 1: PINS

To help align certain parts during assembly, cut **10 pins** about **6mm** long from **3mm** filament. At least 2 of these pins should be the same color as the **body** with nice square cut ends.

Use the supplied **Alignment\_Pins.STL** file to print a set of pins if you don't have 3mm filament.

x10

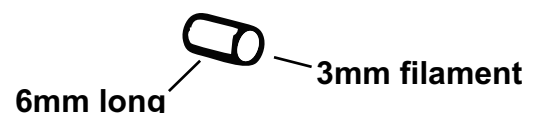

## 2 WHEELS

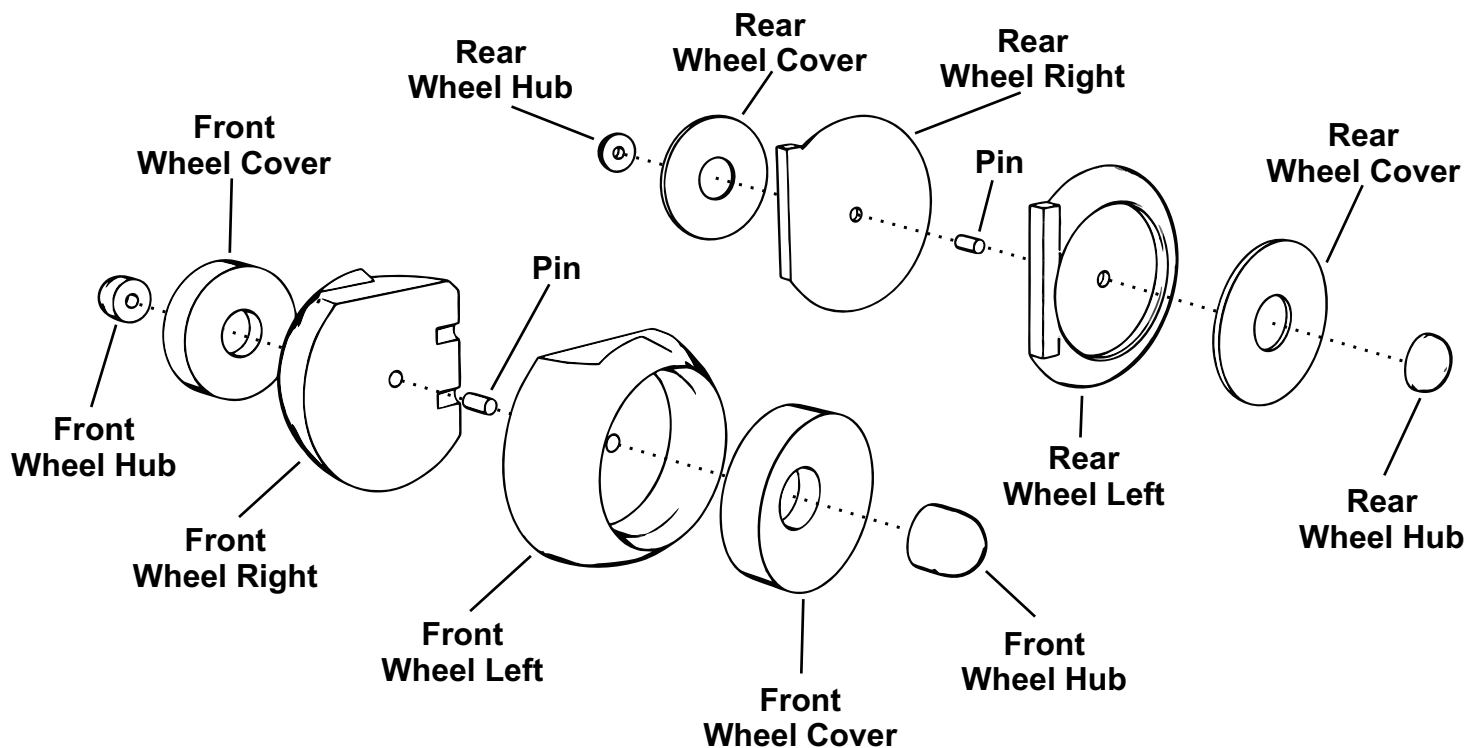

## 3 FRAME

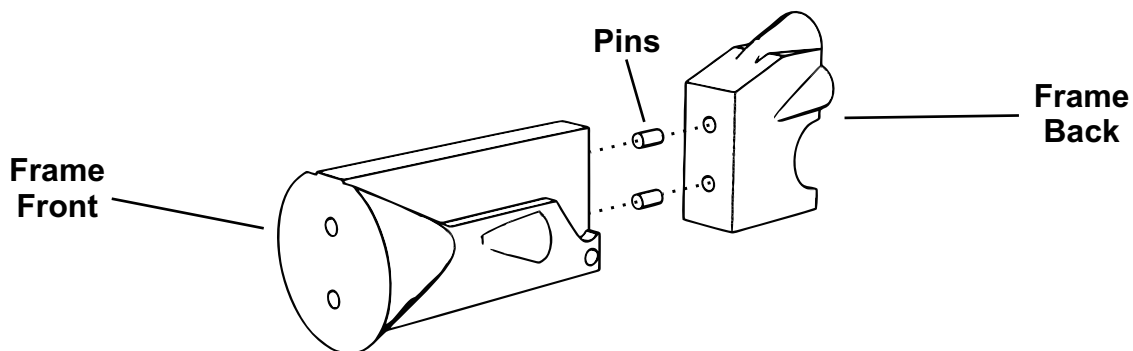

## 4 BODY

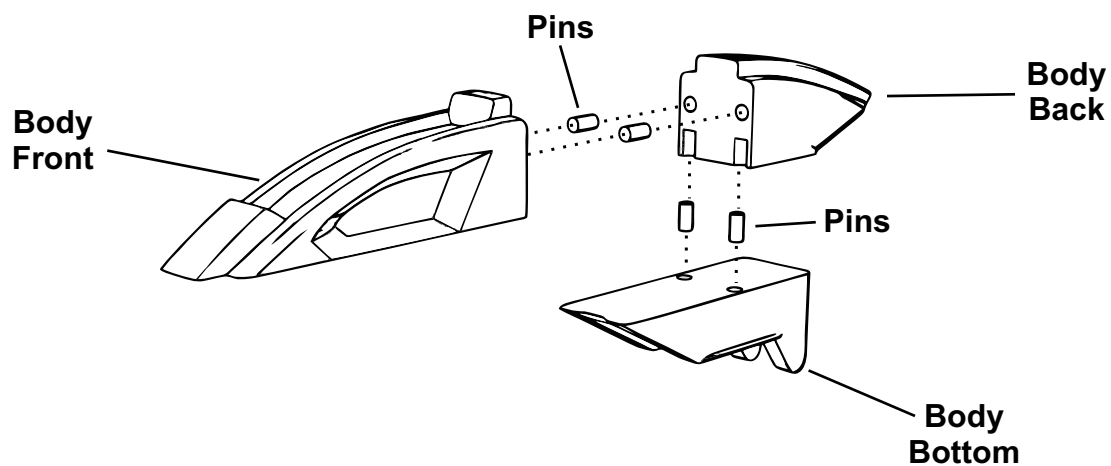

## 5 WINDOWS

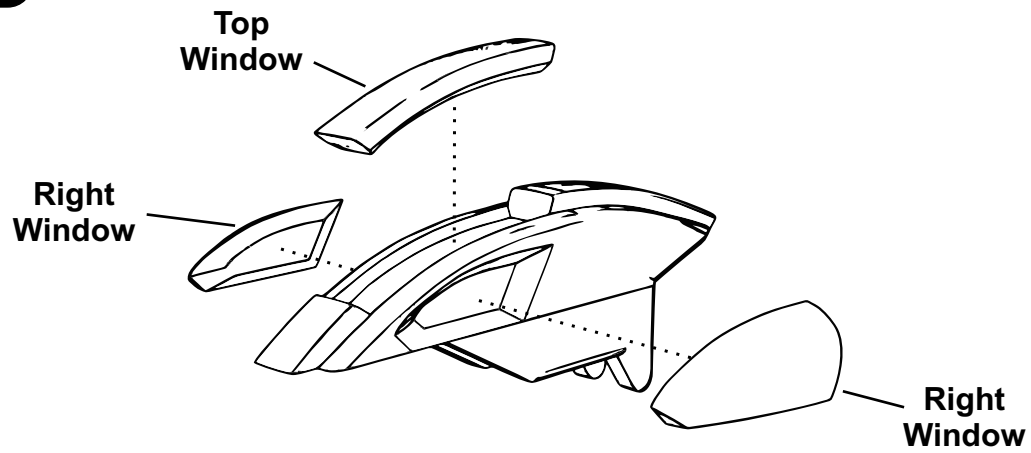

## 6 FINAL ASSEMBLY

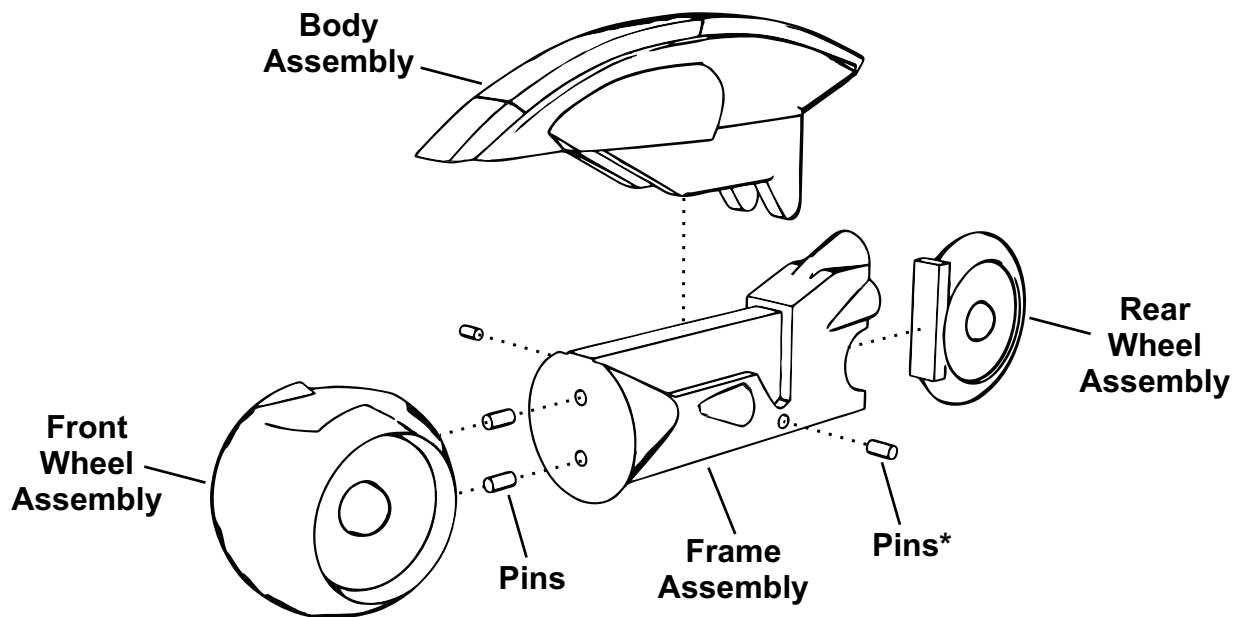

(\*should be the same color as the body)

## 7 DISPLAY STAND

